

## Summary

The International House (Marikoji Kaikan) was built in April 1994 to promote international academic exchange at Kyoto Institute of Technology and regional national universities. This housing for international students and researchers is also open to persons who can significantly contribute to international exchange. We would like you to understand that compared with other accommodations, the rent and fees are reasonable because the building and facilities are now over 30 years old.

## Rooms

Single Room  
(69 rooms)

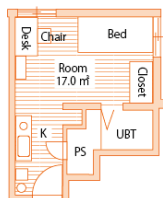

Couple Room  
(12 rooms)

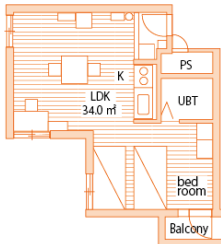

Family Room  
(8 rooms)

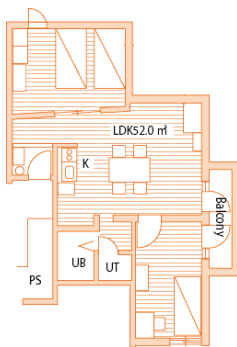

## Furnishings

- Bed
- Cupboard
- Kitchen sink
- IH cooking stove
- Refrigerator
- Electric hot water pot
- Bath room
- Study desk and chair
- Desk lamp
- Book shelf
- Wardrobe
- Shoe box
- Umbrella stand
- Telephone (Internal use only)
- Window blind or curtains
- Air conditioner
- Dust box
- Modem Wi-Fi

### <Couple & Family Room only >

- Dining table
- Dining chair
- Washing machine
- Microwave

- Actual interiors may differ from these photographs.

## Fees (for Students\*)

Monthly Fees	Single Rooms	Couple Rooms	Family Rooms
Rent (per Room)	¥12,600	¥20,300	¥30,300
Common Service Fee (per Room)	¥3,300	¥3,400	¥3,500
Cleaning Fee (per Room. One time fee)	¥15,500	¥24,500	¥32,000
Water Charge (per person)	¥1,600	¥1,600	¥1,600
Membership Fee (per person)	¥500	¥500	¥500
Fire Insurance (per person)	¥550	¥550	¥550
Rental Bed Linen (per person)	¥1,155	¥1,155	¥1,155

- The monthly fees for Rent, Water, Common Service, Membership, Fire insurance and Rental bed linen must be paid every month for the following month.
- Rent and Other Fees are subject to change.
- Fire Insurance fees will be also added to your monthly rent (¥550 per person).

\*Fees for researchers are different from fees for students. Please refer the detail information from QR code. ⇒



## Utilities and other expenses

Fees	Amount	Remarks
Electricity	Based on the amount	Individual contract with Electric Company
Clothes Dryer	¥100 / 60 min.	Located at the Laundry Room (Washing machine use is FREE)

- If you are staying less than 3 months, we will ask you to pay the electricity fee (single room: ¥ 300, couple room: ¥ 400, family room: ¥ 550 per day) for the entire stay in advance upon your arrival.

## Common-use facilities

Study room, Lobby, Japanese-style room, Lounge, Kitchen, Laundry room, Bicycle parking



Study room



Lobby



Japanese-style room



Bicycle parking

## Surroundings

There are drug stores, clinics, convenience stores and fast food restaurants with in a 10 min. walk.



Drug Store



Clinic



Convenience store



Fast food restaurant

## Getting to Kyoto Institute of Technology (Matsugasaki Campus) from Marikoji Kaikan:

 12 minutes by bicycle

 Total: About 30 minutes

1. Walk to Demachiyanagi Station (Keihan railway Eiden). About 8 minutes walking.
2. Take any train and get off at the third stop(E03), Ichijoji station. (6 minutes)
3. Walk to the campus. (15 minutes)

 Total: About 30 minutes

1. Walk to the Kyoto Bus "Demachiyanagi Eki Mae" bus stop (in front of Demachiyanagi Station.) About 8 minutes walking.
2. Take "Kyoto Bus" which is white & burgundy color! No. 16,17,41 and 43. (10-15minutes ride)  
Do not take the green bus!
3. Bus stop is located by the river side. (bound to North)
4. Get off at "Takano Izumicho".
5. Walk to the campus. (5 minutes)

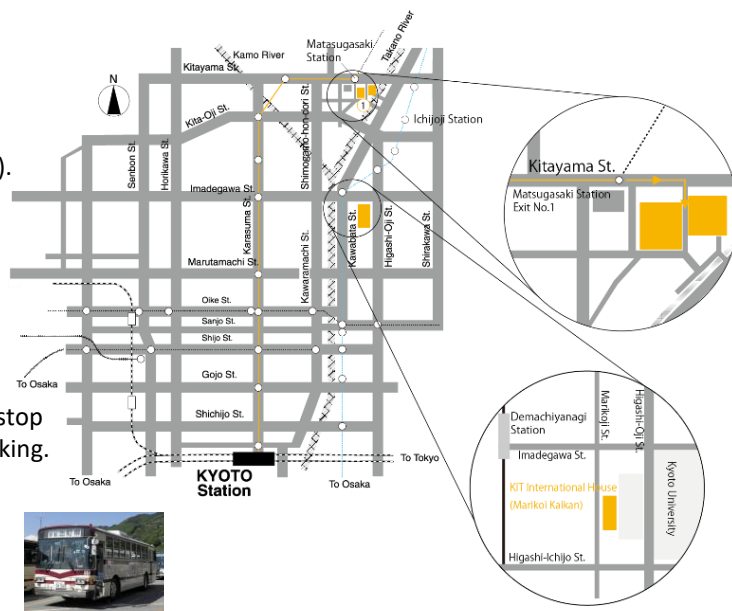

## From Airport (KIX):

- From Kansai International Airport (KIX) to Kyoto Station  
KIX access information: <https://visit.jorudan.co.jp/kix>
- We recommend that you take a taxi from Kyoto station (about ¥3,000) to Marikoji Kaikan.
- Please show the Marikoji Kaikan address to the taxi driver.→
- Please note that Marikoji Kaikan is 3.6km away from KIT.

Address of “KIT International House”

京都市 左京区 吉田泉殿町 6 - 2  
今出川通鞠小路下ル

6-2 Yoshida Izumidonochō, Sakyo-ku, Kyoto